

Waste Lands of the Crown

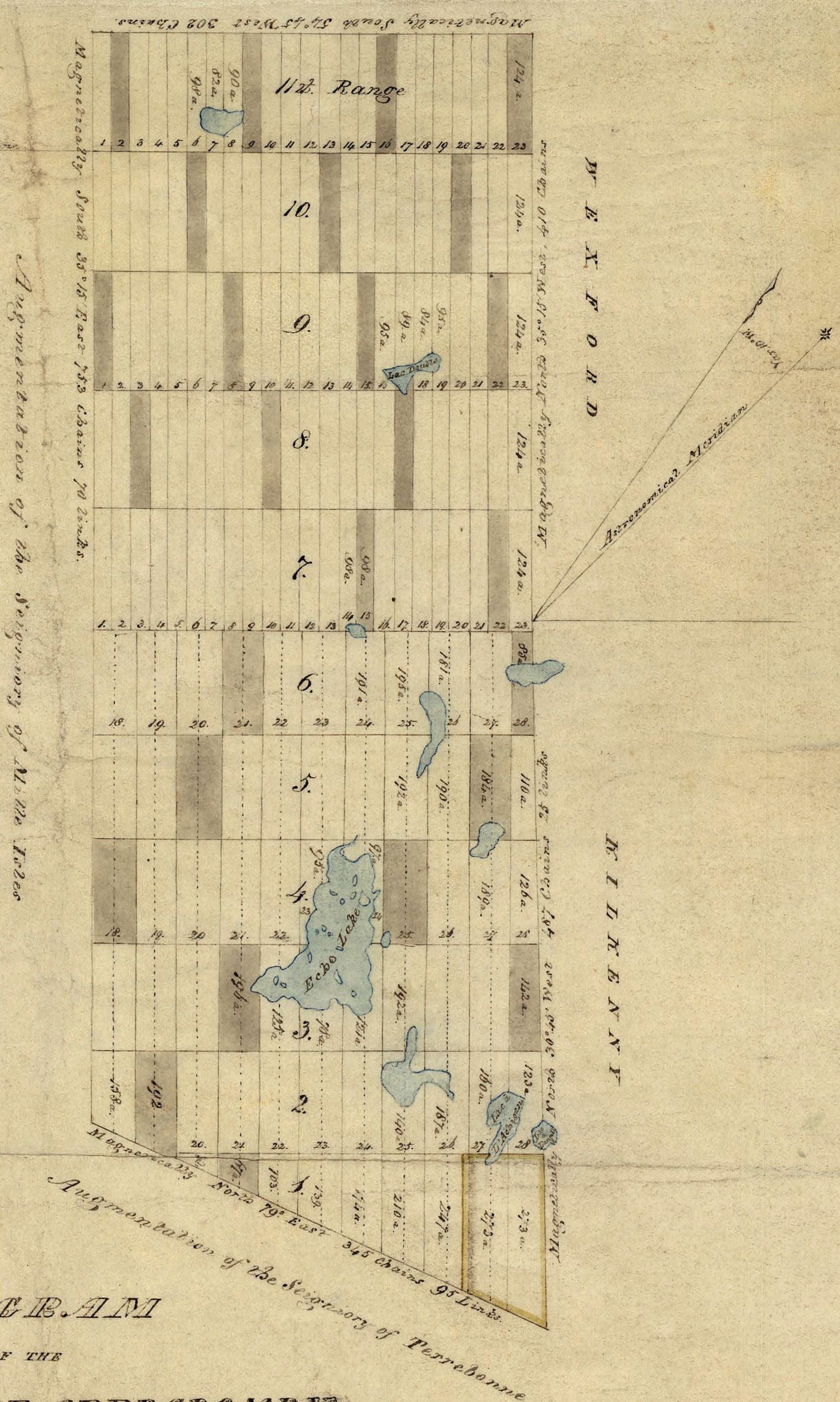

DIAGRAM

OF THE

TOWNSHIP OF ABERCROMBY

Scale 80 Chains to an Inch.

Surveyor General's Office
Kingston, October 20th 1842

Thomas Parke
Sur. Genl.

The lots shaded black are Clergy Reserves
The Contents of the irregular lots are marked
Lockers' grant is edged yellow