

Abraham Joseph

# Plan

of certain Lots of ground or Emplacements  
situate on the Grande Allée, near Quebec,  
to be granted in free & common socage to  
H. J. Scott Esquire



D. B. Papineau  
C. C. L.

John Peirce

F. D: 50° 35' E. 30 feet. G

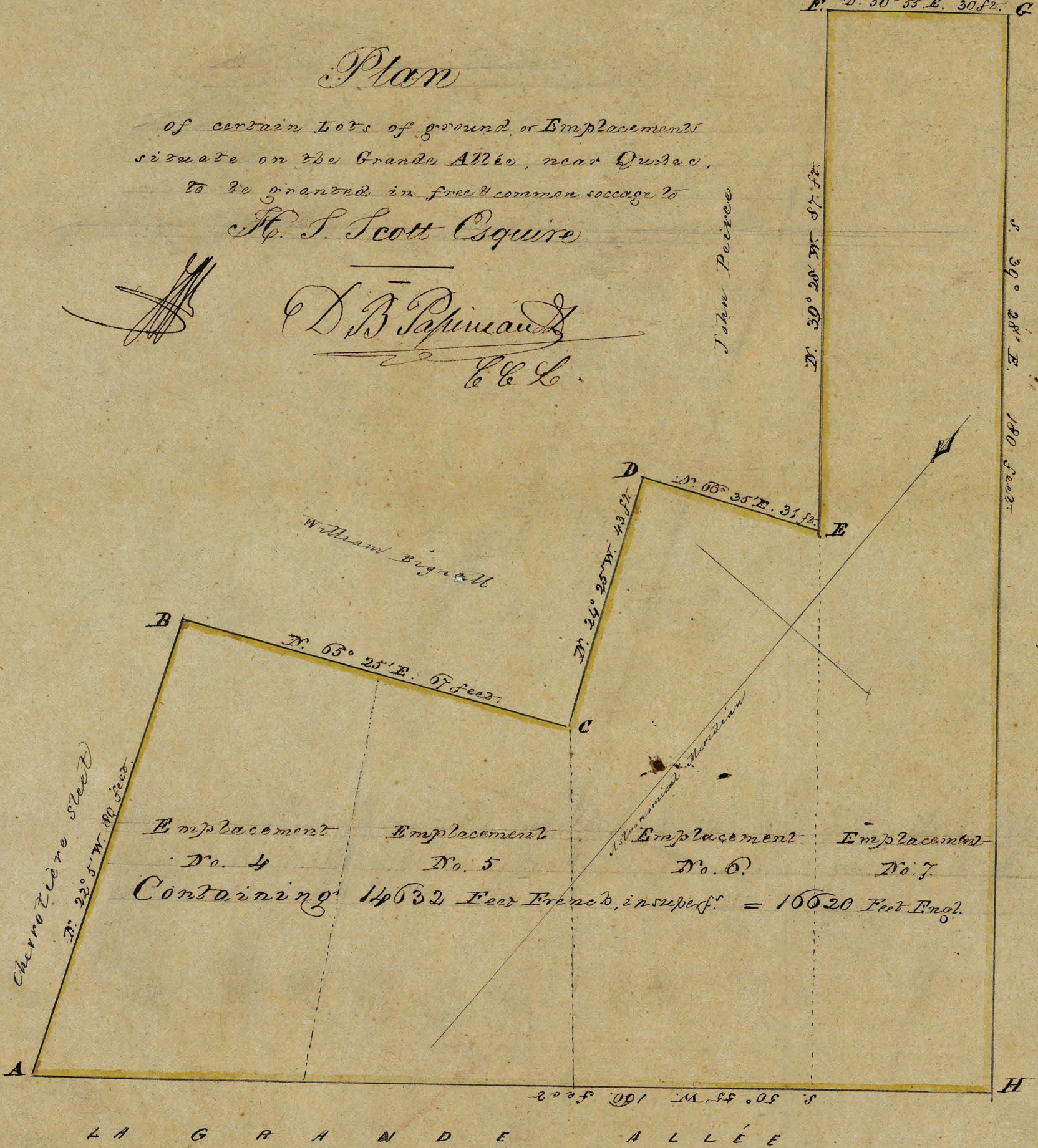

Abraham Joseph  
180 feet

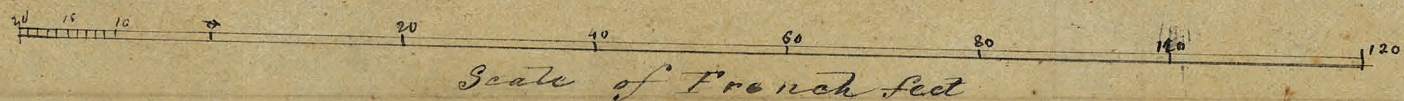

C. L. O. Surveying Department.  
Montreal, 25. Sept. 1847.

Ed 2101, 2220, 2221, 634

Ed sans dimensions et par des lettres

Quebec (Hôtel de Ville) - 1847

2108-1108 # 34